

# Bosch IDS 2.0 BOVA-36 & BOVA-60 Split System Heat Pump

## 5 Ton Capacity

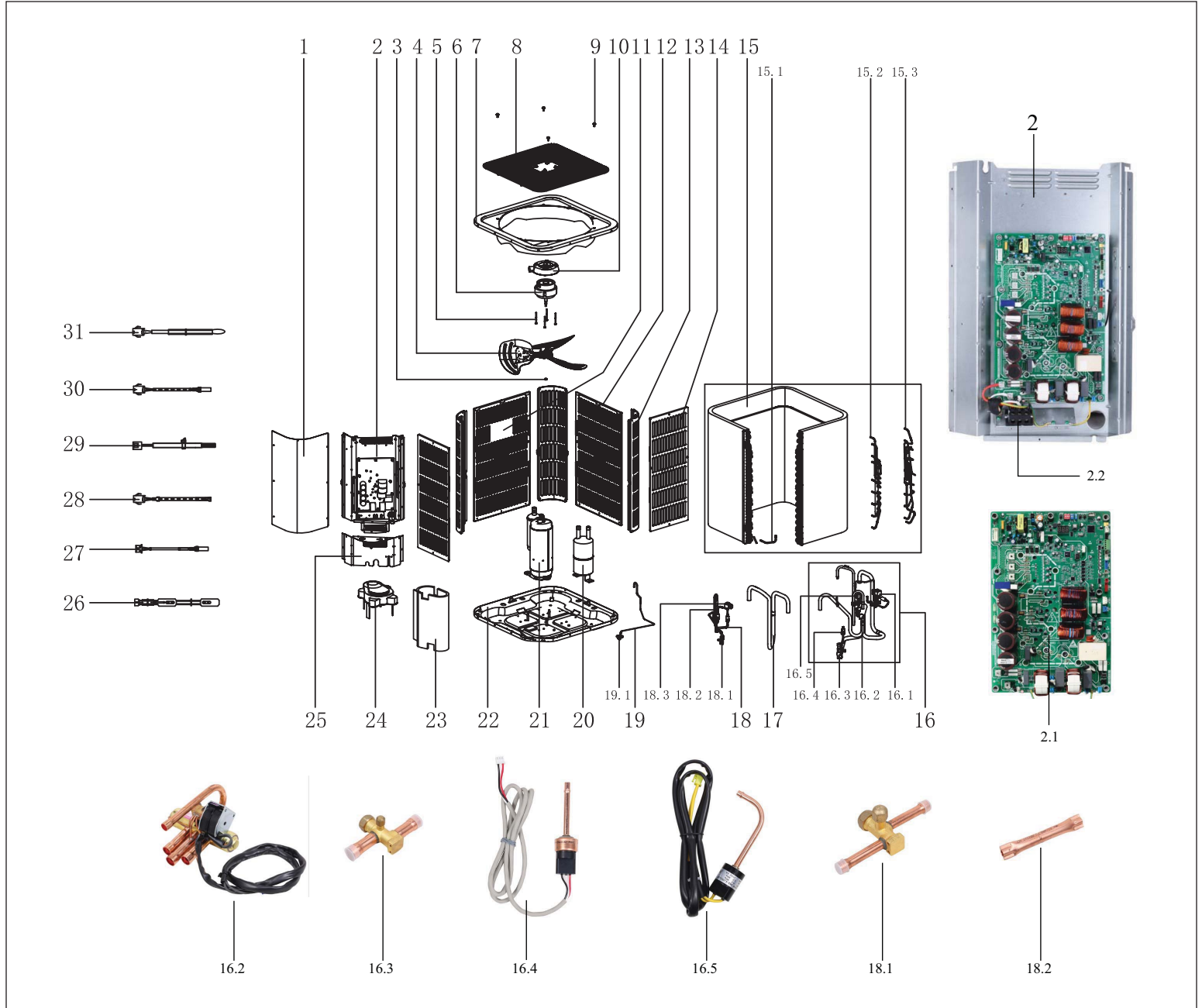

**BOSCH**

Pos.	Description	Qty	Ordering no.	BOVA-60 (5 Ton)	Recommended Stock	Remarks
1	Service Access Panel	1.0	8733953175	■		
2	Control Board Assembly	1.0	8733953176	■	✓	
2.1	Outdoor Control Board	1.0	8733953177	■		
2.1.1	Control Board Temperature Sensor (Tf) (Image not shown. Located behind control board.)	1.0	8733948339	■		
2.2	High Voltage Terminal Block	1.0	8733953148	■		
3	Nuts for outdoor fan	1.0	8733941801	■		
4	Fan blade	1.0	8733953178	■	✓	
5	Motor Mounted Bolt	4.0	8733941845	■		
6	Outdoor ECM Motor	1.0	8733953149	■	✓	
7	Top Cover Assembly	1.0	8733953150	■		
8	Top Cover Grate	1.0	8733941805	■		
9	Top Cover Grate Bolts	4.0	8733941806	■		
10	Motor Installation Board Ass'y	1.0	8733941847	■	✓	
11	Side Coil Guard (with Bosch logo)	1.0	8733954148	■		
12	Side Louver Panel 1	2.0	8733953179	■		
13	Round Louver Panel	3.0	8733953180	■		
14	Side Louver Panel 2	2.0	8733953181	■		
15	Condenser Coil Assembly	1.0	8733953182	■		
15.1	Condenser Transition Pipe	1.0	8733941814	■		
15.2	Condenser Input Assembly	1.0	8733953185	■		
15.3	Condenser Output Assembly	1.0	8733953186	■		
16	Reversing Valve System Assembly	1.0	8733953187	■	✓	
16.1	Pressure Equalizer Valve (PEV)	1.0	8733953158	■	✓	
16.2	Reversing Valve	1.0	8733953159	■	✓	
16.3	Suction Valve	1.0	8733941858	■	✓	
16.4	Pressure transducer	1.0	8733953160	■	✓	
16.5	High pressure switch	1.0	8733941857	■	✓	
17	Suction pipe assembly	1.0	8733953188	■		
18	High Pressure Valve Assembly	1.0	8733941860	■	✓	
18.1	Liquid Valve	1.0	8733941822	■	✓	
18.2	Check Valve	1.0	8733941823	■	✓	
18.3	EEV Assembly	1.0	8733953189	■	✓	
19	Gauge Port Assembly	1.0	8733953190	■		
19.1	Gauge Port	1.0	8733941827	■		
<b>Bosch IDS 2.0 BOVA-60HDN1-M20G Split System Heat Pump 5 Ton Capacity</b>						

